

StudioBell

National
Music
Centre

Centre
National
de Musique



STUDIO BELL RENTAL PACKAGES & SPACES

Our Mission:

To give Canada a place that amplifies the love, sharing, and understanding of music.

Our Vision:

To be a national catalyst for discovery, innovation, and renewal through music.



About NMC

The National Music Centre (NMC), a registered charity is a national catalyst for discovery, innovation, and renewal through music. In our home at Studio Bell—designed by Brad Cloepfil of Allied Works Architecture—NMC preserves and celebrates Canada’s music story, and inspires a new generation of music lovers.

Our Programs

Programming at NMC is innovative, diverse, inclusive, and collaborative. NMC reaches music lovers through programs and exhibitions, including a wide demographic of people from children to professional musicians. NMC delivers programming in four streams: education, exhibitions, incubation, and performance.

Our programs are designed to:

- Provide original and inspiring experiences for all ages.
- Create access to NMC’s exceptional collection.
- Draw on NMC’s rich partnerships, at the regional, national and international levels.
- Provide creative opportunities for musicians, researchers and technicians.

Our Collection

NMC collects artifacts that represent the history of music technology and tells the story of music in Canada. Our collection philosophy is based on accessibility, which brings our collections to life and invites the exploration of sound and history to create new music. Our collection is comprised of more than 2,000 pieces, and is on display to the public and available to Artists in Residence.

Our Exhibitions

Music festivals are the inspiration behind our exhibitions, which merge technology and storytelling to create an immersive and exciting visitor experience. Curiosity drives visitors to explore the sounds, sights, and interactive activities pouring out of 22 individual exhibition stages, encouraging them to engage in an ever-evolving discussion around music in Canada.

About Studio Bell

Studio Bell opened in Calgary's East Village in July 2016 and represents an exciting partnership between NMC and Bell, Canada's largest communications company. This partnership supports NMC's vision to connect with music lovers across Canada and to create an international hub for music and technology. Studio Bell is home to the National Music Centre, a national cultural organization devoted to amplifying a love, sharing, and understanding of music.

What's Inside Studio Bell?

- Five floors of interactive exhibits
- 265-seat performance hall and multiple reception areas
- The NMC Cafe and Gift Shop
- CKUA Radio
- Classrooms
- Recording Studios

NMC Exhibitions Features

- Home of the Canadian Music Hall of Fame, the Canadian Country Music Hall of Fame Collection, the Canadian Songwriters Hall of Fame, and the ADISQ Hall of Fame
- Artifact conservation and restoration workshops
- Artist in Residence program for Canadian and international artists and technicians
- Incorporation of the famed King Eddy Hotel as a restaurant and live music venue
- Backstage Pass tours of three recording studios, including the Rolling Stones Mobile Recording Studio



Facility Areas

For more information or booking inquiries, please call **587-797-4646** or email rentals@nmc.ca

| ROOM | CAPACITY | | | |
|------------------------------|-----------|--------------------|---------------------|-------------|
| | Dinner | Standing Reception | Meeting / Classroom | Theatre |
| STUDIO BELL | | | | |
| Canada Music Square | 75 | 200 | - | 125 |
| Performance Hall | 160 | 250 | - | 264 |
| Soundscape Gallery | 50 | 100 | - | - |
| East Village Skybridge | 100 | 150 | - | 75 |
| KING EDDY | | | | |
| Terrace Commons | 25 | 60 | 25 | - |
| Rooftop Patio | 100 | 190 | - | - |
| ROOM | Boardroom | Standing | Pods (4/pod) | Classroom |
| MEETING ROOMS | | | | |
| Prairie Room | 12 | - | - | - |
| North Canada Room | 15 | 20 | 16 | 14 |
| Central Canada Room | 15 | 25 | 16 | 12 |
| North & Central Canada Rooms | 15/30* | 45 | 25 | 24 |
| Media Centre Room | 20 | 40 | 20 | Theatre: 35 |
| Special Exhibitions Gallery | 60 | 120 | Theatre: 100 | 70 |

* Capacity and rates vary based on configuration, see individual room page for more information.

- Additional costs may apply for Tech services, Event Staff, Ushers and Box Office staff, Security and Cleaning. Refer to Staff and Resource rates for more information.
- Prairie, North and Central Canada Rooms feature complimentary plug and play technology.
- All rates subject to change without notice.
- 20% NFP discount available to qualified agencies. Proof of charitable status is required

Performance Hall

Level 2 East Block

3, 300 ft • 75.4' x 44.5'

The Performance Hall is the centerpiece of Studio Bell. With fully retractable seats and an acoustic wall that can be opened or closed, the Performance Hall offers flexibility for a variety of events. Host a private reception or seminar, screen a film, or dance the night away to your favourite local band or DJ.

Packages

All Performance Hall packages include:

- Event Host, Event Tech, Security, and Cleaning Staff
- Applicable SOCAN fees
- Customized lighting
- Piped-in background music
- Two NMC Tech walk-throughs (post-contract signing)
- Can be combined with Soundscapes or Canada Music Square for an additional fee

| | |
|---|-------------|
| 8 hour rental Seated Dinner (160 ppl) or Reception (250 ppl) | \$8,660.00 |
| 12 hour rental Seated Dinner (160 ppl) or Reception (250 ppl) | \$12,980.00 |
| Theatre Seating 6 hour rental (264 ppl) | \$6,160.00 |
| Theatre Seating 8 hour rental (264 ppl) | \$8,445.00 |
| Theatre Seating 12 hour rental (264 ppl) | \$12,655.00 |

- Evening events start after 5:00 pm
- Events with a technical component or live music require a minimum two-hour set up
- Additional costs may apply for Tech services, Event Staff, Ushers and Box Office staff, Security and Cleaning. Refer to Staff and Resource rates for more information
- 20% NFP discount available to qualified agencies. Proof of charitable status is required
- All rates subject to change without notice

- A** Made in Canada
- B** Soundscapes
- C** Trailblazers
- D** Performance Hall
- E** Where Music Lives
- II** Electrical outlets

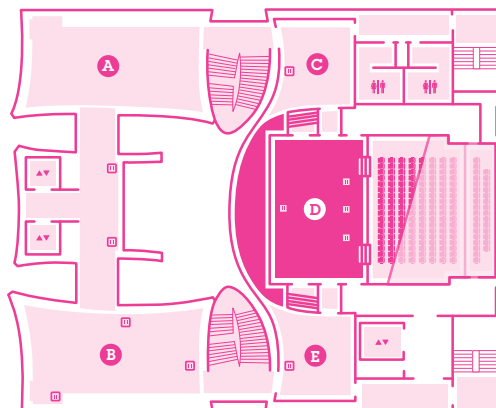

Photo: NMC



Photo: Neil Zeller



Photo: Neil Zeller

Soundscapes Gallery

Level 2 East Block

1, 230 sq ft • 51' x 24.2'

The Soundscapes Gallery features an award winning audio-visual installation showcasing the breadth of Canadian Music from coast to coast to coast. An ideal setting for an intimate dinner or reception space.

Package

Soundscape packages include:

- Event Host, Event Tech, Security, and Cleaning Staff
- Access to 2nd floor galleries
- Applicable SOCAN fees
- Piped-in Background Music
- One NMC Tech walk-through (post-contract signing)

| | |
|---|-------------------|
| 6 hour rental Reception (100 ppl) | \$3,000.00 |
|---|-------------------|

- Evening events start after 5:00 pm
- Rates are based on a six-hour booking (including load-in and load-out time)
- Additional costs may apply for Tech services, Event Staff, Ushers and Box Office staff, Security and Cleaning. Refer to Staff and Resource rates for more information
- 20% NFP discount available to qualified agencies. Proof of charitable status is required
- All rates subject to change without notice

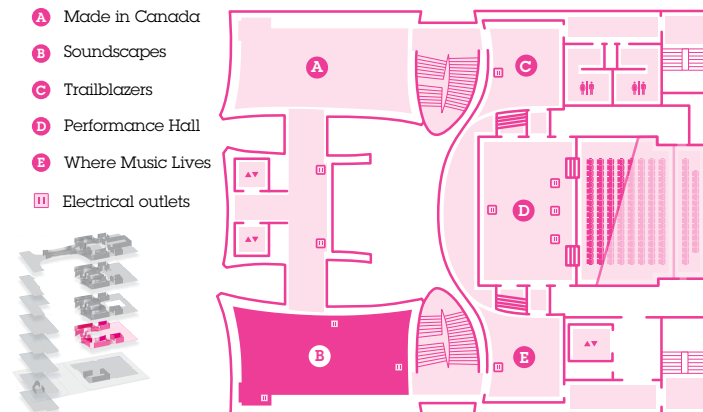

East Village Skybridge

Level 5 East Block

1,700 sq ft • 83.6' x 20.8'

The East Village Skybridge offers one-of-a-kind views south toward the Stampede grounds and north into the east village and beyond. This open space is perfect for evening receptions or for an intimate dinner. It can also be transformed into a concert venue and is great for dance parties.

Packages

All EV Skybridge packages include:

- Event Host, Event Tech, Security, and Cleaning Staff
- Access to 5th floor galleries
- Applicable SOCAN fees
- Piped-in background music
- One NMC Tech walk-through (post-contract signing)

| | |
|---|------------|
| 6 hour rental Seated Dinner (100 ppl) or Reception (150 ppl) | \$3,985.00 |
| 8 hour rental Seated Dinner (100 ppl) or Reception (150 ppl) | \$5,285.00 |
| 12 hour rental Seated Dinner (100 ppl) or Reception (150 ppl) | \$8,330.00 |

- Events start after 5:00 pm
- Events with a technical component require a minimum two-hour set up
- Additional costs may apply for Tech services, Event Staff, Ushers and Box Office staff, Security and Cleaning. Refer to Staff and Resource rates for more information
- 20% NFP discount available to qualified agencies. Proof of charitable status is required
- All rates subject to change without notice

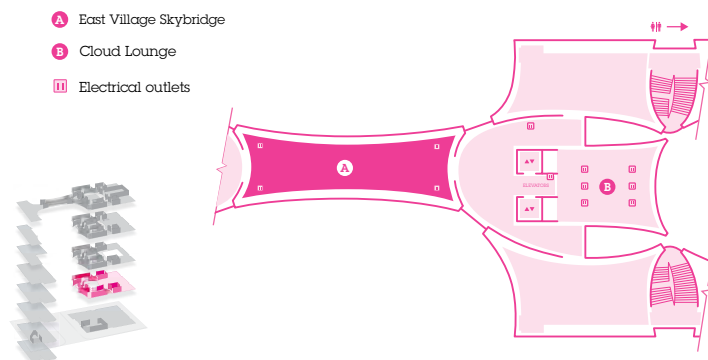

Studio Bell • Full Building

Level 1 to 5 East Block

22,000 sq. ft

Studio Bell is a spectacular and memorable venue for large scale events. Guests will be able to take in the awe-inspiring architecture from every angle and explore the galleries as they travel between the Canada Music Square, the Performance Hall, and the East Village Skybridge.

Package

Full building rental includes:

- Event Host, Event Tech, Security, and Cleaning Staff
- Full building access (galleries level 1-5 and event spaces)
- Applicable SOCAN fees
- Customized lighting
- Piped-in background music
- Up to three NMC Tech walk-throughs (post-contract signing)

| | |
|--|--------------------|
| <p>12 hour rental Reception (1,500 ppl)</p> | <p>\$36,000.00</p> |
|--|--------------------|

- Evening events start after 5:00 pm
- Events with a technical component require a minimum two-hour set up
- Additional costs may apply for Tech services, Event Staff, Ushers and Box Office staff, Security and Cleaning. Refer to Staff and Resource rates for more information
- 20% NFP discount available to qualified agencies. Proof of charitable status is required
- All rates subject to change without notice

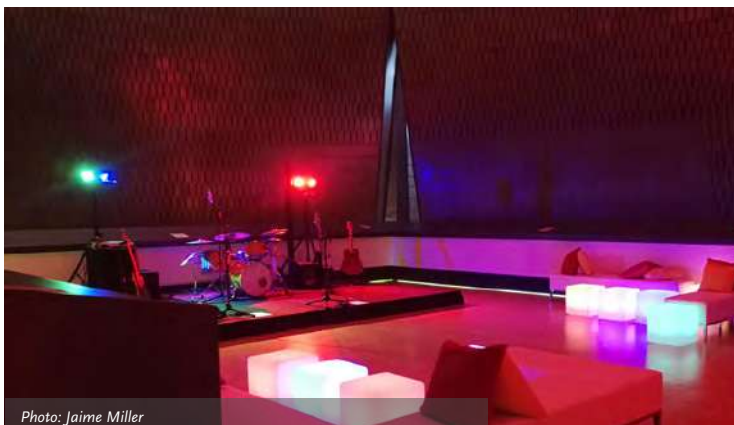
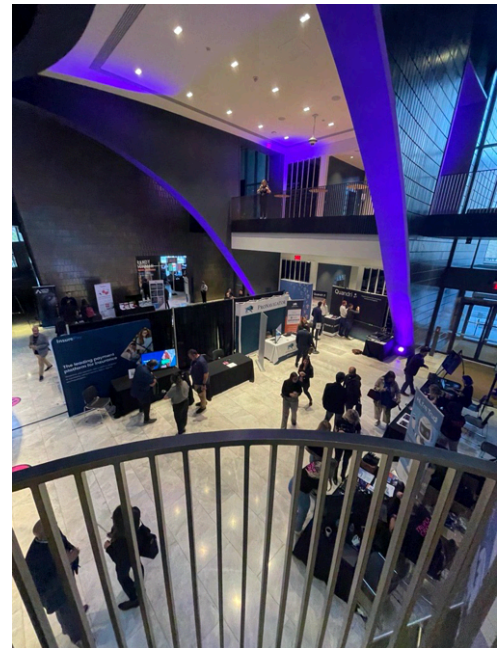

Photo: Jaime Miller

Photo: Brenna Pladsen

Prairie Room

Level 3 West Block

430 sq ft • 27' x 16'

The Prairie Room offers stately details and “plug-and-play” technology with full web conferencing capabilities. It is the perfect meeting space for groups of up to 12.

Capacity

| | |
|-----------|----|
| Boardroom | 12 |
|-----------|----|

Rates

(3 hour min.)

| | |
|---------|-----------|
| Daily * | \$65/hour |
|---------|-----------|

* Rate applicable for Monday to Friday 9 am to 5 pm meetings. Additional charges may apply for staffing evenings and weekends

- Includes one Event Host
- Additional costs may apply for Tech services, Event Staff, Security and Cleaning. Refer to Staff and Resource rates for more information
- Features complimentary wi-fi and plug and play technology
- 20% NFP discount available to qualified agencies. Proof of charitable status is required
- All rates subject to change without notice



Photo: Gabriella Gut



Photo: Neil Zeller

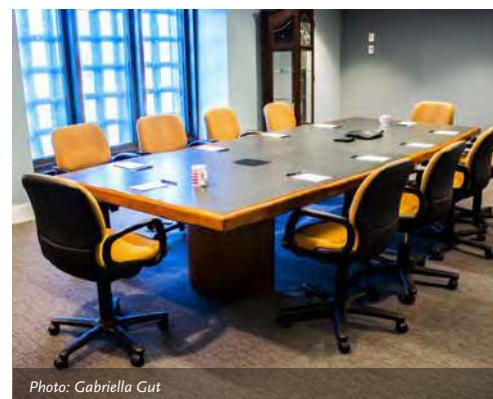
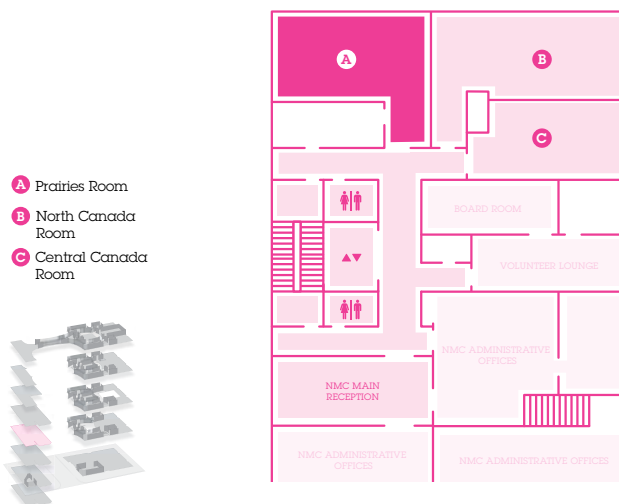

Photo: Gabriella Gut



Central Canada Room

Level 3 West Block

Central Canada Room 390 sq ft • 26' x 15'

This room offers the “plug-and-play” technology. Central Canada is perfect for board meetings up to 15, and can be joined with North Canada Room for a classroom style configuration, or break-out group sessions for up to 25 participants.

Capacity

| | |
|---------------------|----|
| Boardroom | 15 |
| Standing Reception | 25 |
| Pods (4 guests/pod) | 16 |
| Classroom | 12 |

Rates

(3 hour min.)

| | |
|-------------------------|------------|
| Daily * | \$65/hour |
| Central + North Rooms * | \$120/hour |

* Rate applicable for Monday to Friday 9 am to 5 pm meetings. Additional charges may apply for staffing evenings and weekends

- Includes one Event Host
- Additional costs may apply for Tech services, Event Staff, Security and Cleaning. Refer to Staff and Resource rates for more information
- Features complimentary wi-fi and plug and play technology
- 20% NFP discount available to qualified agencies. Proof of charitable status is required
- All rates subject to change without notice



Photo: Gabriella Gut



Photo: Gabriella Gut

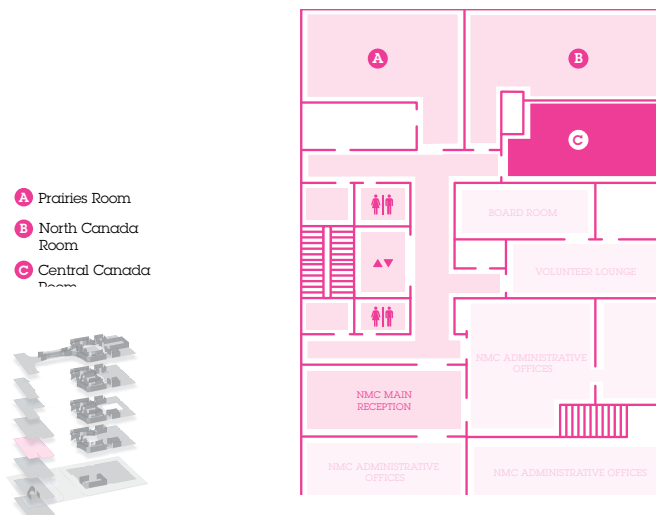

North Canada Room

Level 3 West Block

North Canada Room 580 sq ft • 35.3' x 16.5'

This room offers “plug-and-play” technology. North Canada is perfect for tel-conferences, and can be joined with Central Canada Room for a classroom style configuration, or break-out group sessions for up to 25 participants.

Capacity

| | |
|---------------------|----|
| Boardroom | 15 |
| Standing Reception | 20 |
| Pods (4 guests/pod) | 16 |
| Classroom | 14 |

Rates

(3 hour min.)

| | |
|-------------------------|------------|
| Daily * | \$65/hour |
| North + Central Rooms * | \$120/hour |

* Rate applicable for Monday to Friday 9 am to 5 pm meetings. Additional charges may apply for staffing evenings and weekends

- Includes one Event Host
- Additional costs may apply for Tech services, Event Staff, Security and Cleaning. Refer to Staff and Resource rates for more information
- Features complimentary wi-fi and plug and play technology
- 20% NFP discount available to qualified agencies. Proof of charitable status is required
- All rates subject to change without notice



Photo: Neil Zeller



Photo: Gabriella Gut



North Canada & Central Canada Rooms

Level 3 West Block

North Canada Room 580 sq ft • 35.3' x 16.5' | Central Canada Room 390 sq ft • 26' x 15'

Both rooms offer “plug-and-play” technology. The rooms can be joined together for a classroom style configuration, or break-out group sessions for up to 25 participants.

Capacity

| | |
|---------------------|--------|
| Boardroom | 15/30* |
| Standing Reception | 45 |
| Pods (4 guests/pod) | 25 |
| Classroom | 24 |

Rates

(3 hour min.)

| | |
|------------------------|------------|
| Combined as one room * | \$120/hour |
|------------------------|------------|

* Rate applicable for Monday to Friday 9 am to 5 pm meetings. Additional charges may apply for staffing evenings and weekends

- Includes one Event Host
- Additional costs may apply for Tech services, Event Staff, Security and Cleaning. Refer to Staff and Resource rates for more information
- Features complimentary wi-fi and plug and play technology
- 20% NFP discount available to qualified agencies. Proof of charitable status is required
- All rates subject to change without notice

* Capacity and rates vary based on configuration, see individual room page for more information.

- A** Prairies Room
- B** North Canada Room
- C** Central Canada Room

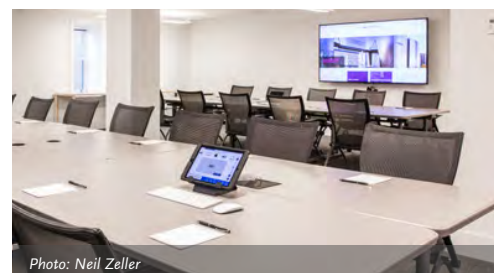
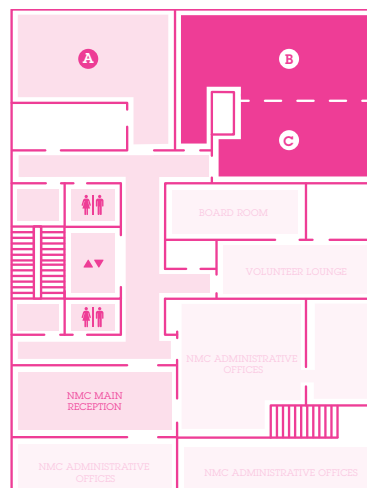
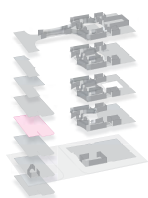

Media Centre Room

Level 7 West Block

525 sq ft • 21' x 25'

The Media Centre Room offers stately details and “plug-and-play” technology with full web conferencing capabilities. It is the perfect meeting space for groups of up to 35.

Capacity

| | |
|---------------------|----|
| Boardroom | 20 |
| Standing Reception | 40 |
| Pods (4 guests/pod) | 20 |
| Theatre Seating | 35 |

Rates

(3 hour min.)

| | |
|-------|------------|
| Daily | \$150/hour |
|-------|------------|

- Includes one Event Host
- Additional costs may apply for Tech services, Event Staff, Security and Cleaning. Refer to Staff and Resource rates for more information
- Features complimentary wi-fi and plug and play technology
- 20% NFP discount available to qualified agencies. Proof of charitable status is required
- All rates subject to change without notice

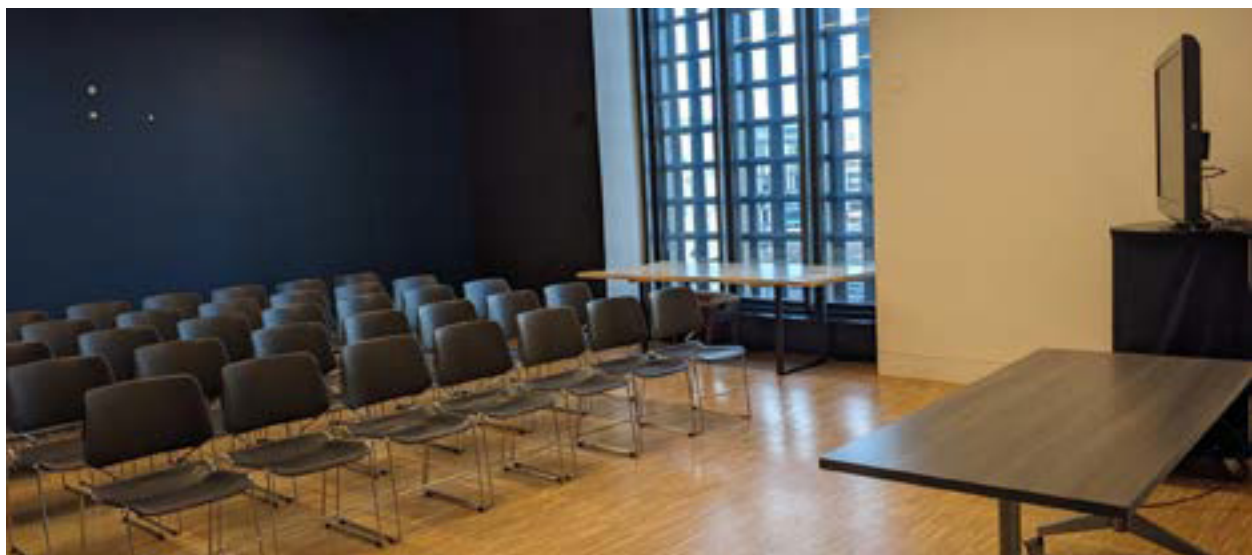
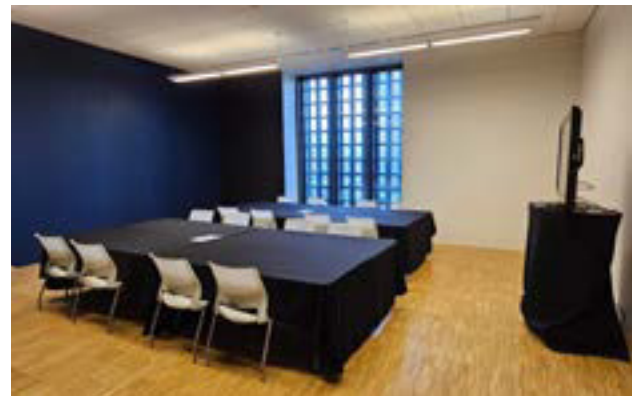
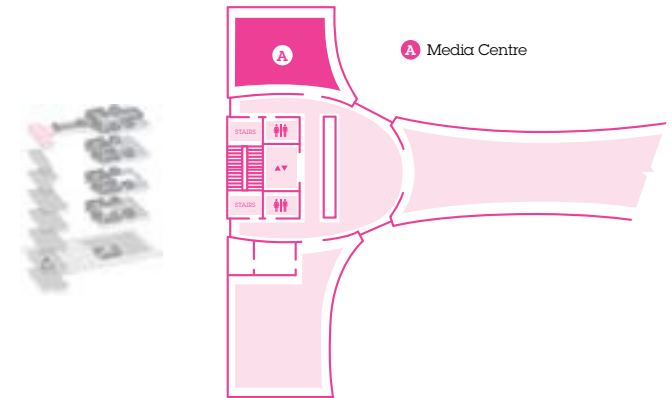

Special Exhibitions Gallery

Level 5 East Block

2285 sq ft • 65' x 35'

This room offers “plug-and-play” technology. Special Exhibitions is perfect for large meetings, presentations, intimate meals or receptions and break-out group sessions for up to 100 participants.

Capacity

| | |
|--------------------|-----|
| Boardroom | 60 |
| Standing Reception | 120 |
| Theatre | 100 |
| Classroom | 70 |

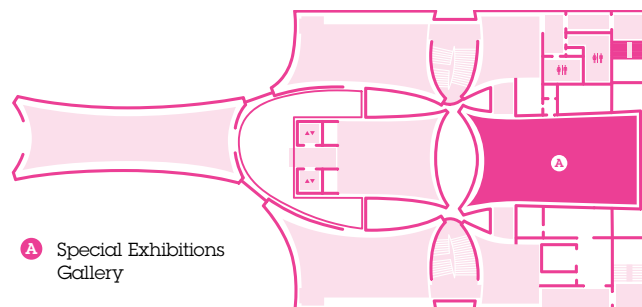

Rates

(3 hour min.)

| | | |
|-------|------------|--|
| Daily | \$500/hour | Subject to availability. Please inquire. |
|-------|------------|--|

- Includes 1 x Event Host and 2 x Tech for the duration of the rental.
- 1 x 52-inch TV screen. Larger Screen upgrades available at an additional cost.
- Chairs for theatre seating (up to 100 guests).
- Includes mobile audio cart.
- Additional costs may apply for Tech services, Event Staff, Security and Cleaning. Refer to Staff and Resource rates for more information.
- Features complimentary wi-fi and plug and play technology.
- 20% NFP discounts available to qualified agencies. Proof of charitable status is required.
- All rates subject to change without notice.
- Capacity and rates vary based on configuration, see individual room page for more information.



NMC Preferred Caterers

King Eddy — NMC In-house Caterer

Catering Team
events@kingeddy.ca
403.829.6016

Fairmont Palliser

Conference Services and Events Team
palcatering@fairmont.com

Hyatt

Debbie Vollmann
Associate Director of Events
debbie.vollmann@hyatt.com
403.537.4483

Gather Catering

Carla Cole
info@gathercatering.ca

Concept Catering

Duncan Ly
duncan@foreignconcept.ca

Hotel Arts

Kimberly Dobbins
Associate Director of Events &
Conference Services
kdobbins@hotelarts.ca
403.206.9563

Simply Elegant Catering

Guru Dod
Food & Beverage Manager
catering@secorp.ca
403.242.0598

Staff and Resource Rates

Staffing*

| ADDITIONAL STAFF | HOURLY RATE (min 3 hours) |
|--------------------|---------------------------|
| Event Host | \$40 |
| Event Staff | \$35 |
| Tech Lead | \$75 |
| Tech Staff | \$75 |
| Lighting Tech | \$75 |
| Collections Staff | \$75 |
| Box Office | \$35 |
| | |
| Kimball Organist | \$250 base rate |
| Event Interpreters | \$250/guide |
| Security | \$45 |
| Cleaners | \$40 |

Additional Resources*

| S/B ITEM | RATE |
|--|------------|
| Confidence Monitor | \$350 |
| Performance Hall seat retraction | \$750 |
| Performance Hall Air Wall | \$500 |
| Performance Hall projector and screen | \$1200 |
| Perfect Cue | \$175 |
| Simple Lectern | \$250 |
| Cocktail Table | \$15 |
| Blue Couch Three Seater | \$175 |
| Bench, Grey Crescent | \$250 |
| Mobile Audio Cart - Basic tech (mic, mic stand, 2 small speakers, music stand) | \$600 |
| Uplighting LED (PARCAN) | \$50/light |
| 52" flat screen TV | \$300 |
| 60" flat screen TV | \$500 |
| Additional Laptops | \$300 |
| Grand Piano, Yamaha C7 Grand Piano, Bechstein *includes tuning | \$1000 |

Box Office*

| OPTION 1: NMC BOX OFFICE | |
|------------------------------------|-------|
| Set-up fee | \$300 |
| per ticket surcharge | \$4 |
| OPTION 2: THIRD PARTY TICKET AGENT | |
| per ticket surcharge | \$4 |

Additional Fees

- Additional SOCAN Tariffs may apply
- Extra charges may be added for additional equipment rentals. Additional rentals will be added on a per event basis and are dependent upon the size and complexity of the event
- All rates subject to change without notice

NMC Venue Rentals – FAQ

VENUE ACCESS

Access to the venue is given no earlier than the start time stipulated on the contract. Please factor in adequate time for set-up, sound checks, catering, rehearsals, etc., when choosing your contracted start and end time. Additional time is dependent on availability and subject to additional fees.

DO WE HAVE ACCESS TO ALL OF STUDIO BELL?

No, venue access only applies to the floor of the space booked. For example, booking the Performance Hall provides your guests with full access to the 2nd floor but does not allow access to the 3rd, 4th, and 5th floors. Booking the Skybridge will provide your guests with full access to the 5th floor but does not allow access to the 2nd, 3rd, and 4th floors. Access to galleries on venue floors is subject to availability.

Tours of the collection are also available. You can receive more information from NMC's Sales and Event Specialist at the time of your booking.

DO YOU HAVE A P.A. SYSTEM?

Yes, the Performance Hall has a built in P.A. system. Tech services can be provided for all event spaces in Studio Bell. Additional P.A. rentals may apply.

DO YOU PROVIDE CATERING?

No, NMC does not provide catering but works closely with preferred catering partners. Please refer to the Studio Bell rentals package for a list of our preferred catering partners.

An Alberta liquor license is required for all events serving alcohol. A liquor license can be provided by any of the preferred catering partners.

IS THERE PARKING AVAILABLE?

Studio Bell does not have on-site parking, but ample parking is available throughout the East Village.

DO YOU REQUIRE A DEPOSIT?

Yes, we require a 50% deposit once the contract has been signed to confirm the booking.

WHEN IS FULL PAYMENT DUE?

The full balance is due on the date of your event or no more than 30 days following the scheduled event date. Interest rates apply to all overdue accounts. Payment can be made by Electronic Funds Transfer, Visa, MasterCard, cash or cheque.

DOES NMC PROVIDE EVENT SET-UP OR DÉCOR (TABLES, CHAIRS, ETC.)?

Depending on the event size, furniture and decor set-up can be managed by NMC and/or the preferred caterer.

Please note that as a museum housing hundreds of sensitive artifacts, we have extremely strict décor restrictions. Restrictions include (but are not limited to) no open flames, no balloons, no glitter, no confetti, etc. Please ask your NMC Sales and Event Specialist for a list of restrictions.

DOES NMC PROVIDE ENTERTAINMENT?

No, NMC does not provide entertainment, but we are more than happy to provide entertainment agency recommendations who will help you find the right entertainment for your event.

IS EVENT SECURITY MANDATORY?

Yes, all events hosted at Studio Bell require NMC event security.